

NOTES

- All Sewer Main Pipes are Ø160 PE21 PE100 Class SDR21, unless noted otherwise.
- All Sewer House Connections are Ø110 PE, unless noted otherwise.

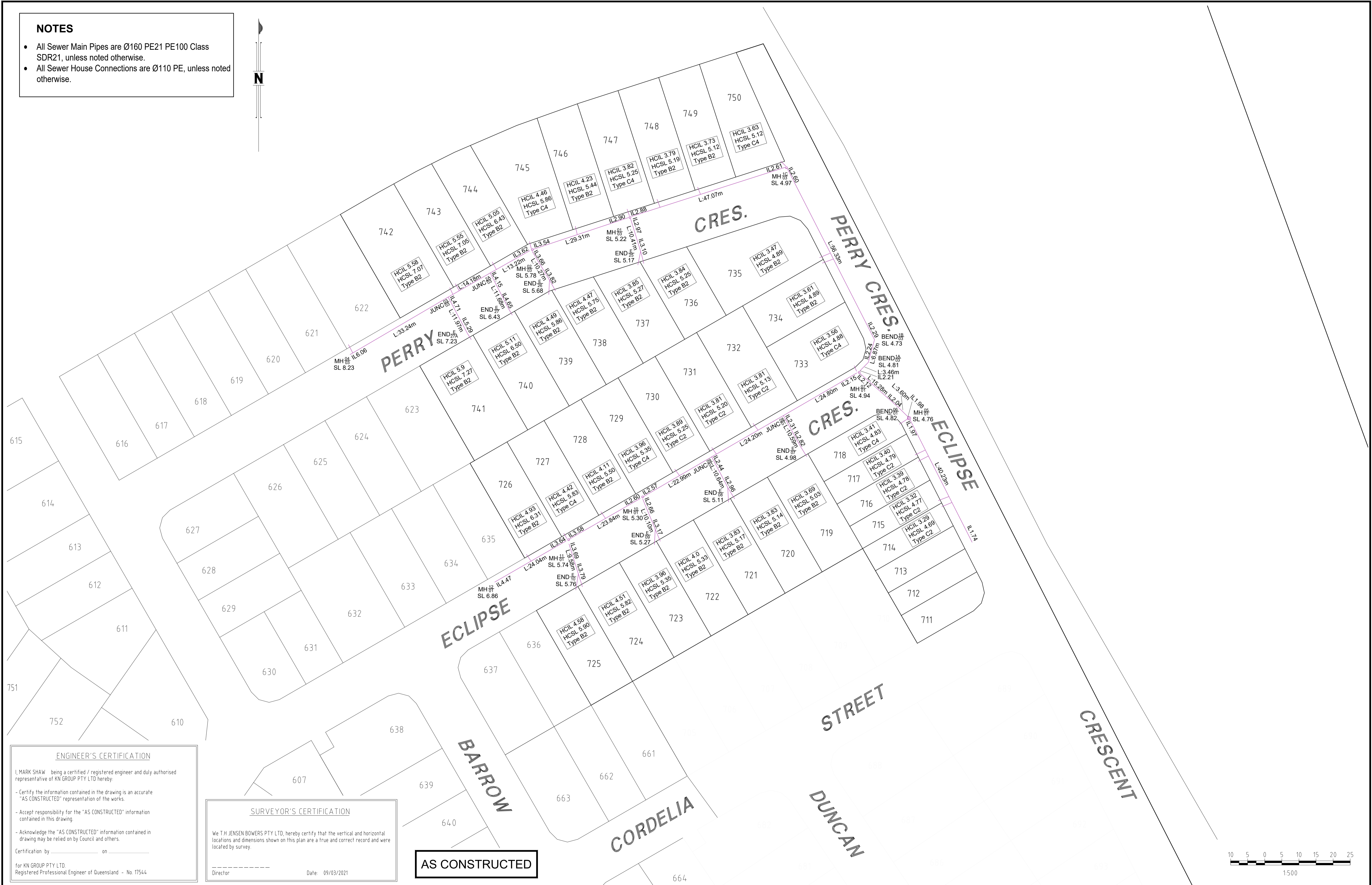
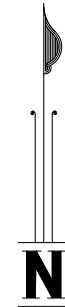

ENGINEER'S CERTIFICATION

I, MARK SHAW, being a certified / registered engineer and duly authorised representative of KN GROUP PTY LTD hereby:

- Certify the information contained in the drawing is an accurate "AS CONSTRUCTED" representation of the works.
- Accept responsibility for the "AS CONSTRUCTED" information contained in this drawing.
- Acknowledge the "AS CONSTRUCTED" information contained in drawing may be relied on by Council and others.

Certification by _____ on _____

for KN GROUP PTY LTD.
Registered Professional Engineer of Queensland - No. 17544

SURVEYOR'S CERTIFICATION

We T.H. JENSEN BOWERS PTY LTD, hereby certify that the vertical and horizontal locations and dimensions shown on this plan are a true and correct record and were located by survey.

Director _____ Date: 09/03/2021

AS CONSTRUCTED

A1	B	05/03/2021	Updated elements	JB	SJM	DB	DRAWN	JB	23/02/2021
	A	23/02/2021	Original Issue	JB	SJM	DB	CHECKED	SJM	23/02/2021
							PASSED	DB	09/03/2021
	INDEX	DATE	REVISIONS	DRAWN	CHECKED	PASSED		INITIALS	DATE

JENSEN BOWERS

SURVEYORS PLANNERS DEVELOPMENT ADVISORS

72 Costin Street, Fortitude Valley, Qld. 4006
PO Box 799, Spring Hill, Qld. 4004
T (07) 3852 1771 F (07) 3252 9818
T.H. Jensen & Bowers Pty. Ltd. (Consulting Surveyors)
ABN: 52 010 872 607
© Copyright reserved to Jensen Bowers Group Consultants Pty Ltd



Unitywater

09/03/2021
NORTHEAST BUSINESS PARK C/ - KN GROUP PTY LTD CONSULTING ENGINEERS
NORTH HARBOUR - STAGE 4S
AS CONSTRUCTED SEWER RETICULATION

SHEET 1 OF 1 SHEETS	SCALE 1:500
REVISION DATE 09/03/2021	REVISION B
DISCIPLINE CODE	
DRAWING NO. U-2021-0203	